

groove F2A to fit
over u/c wire
trap wire between
F2 & F2A

22 swg wire



F2 upright 1/20 balsa



F3 upright 1/20 balsa

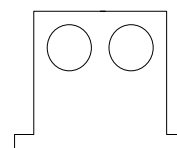

Y 1/20 balsa

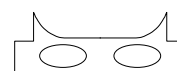

X 1/20 balsa

Peter Rake's
Bostonian

Copyright P. Rake 2016

Peter Rake's
Bostonian

Copyright P. Rake 2016



WT 1/20 balsa



R2 1/20 balsa

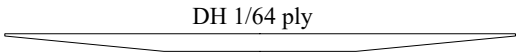
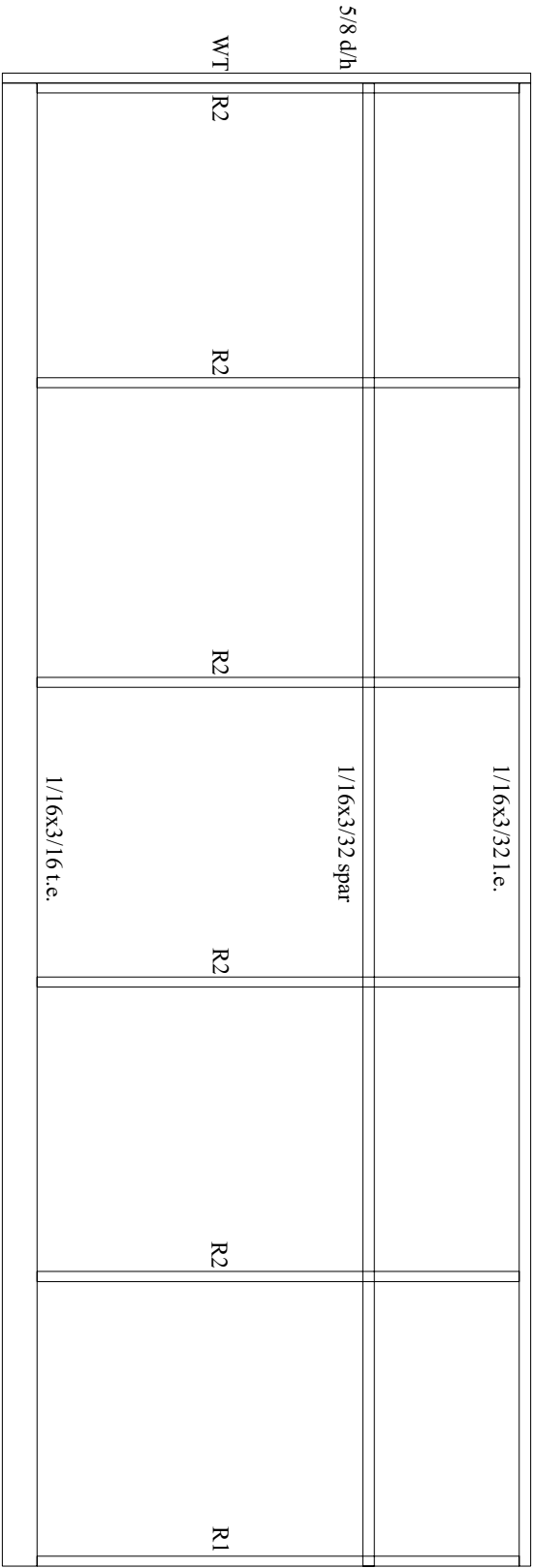
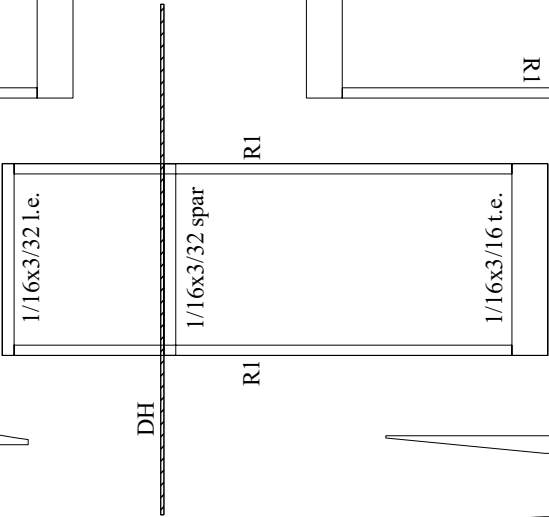
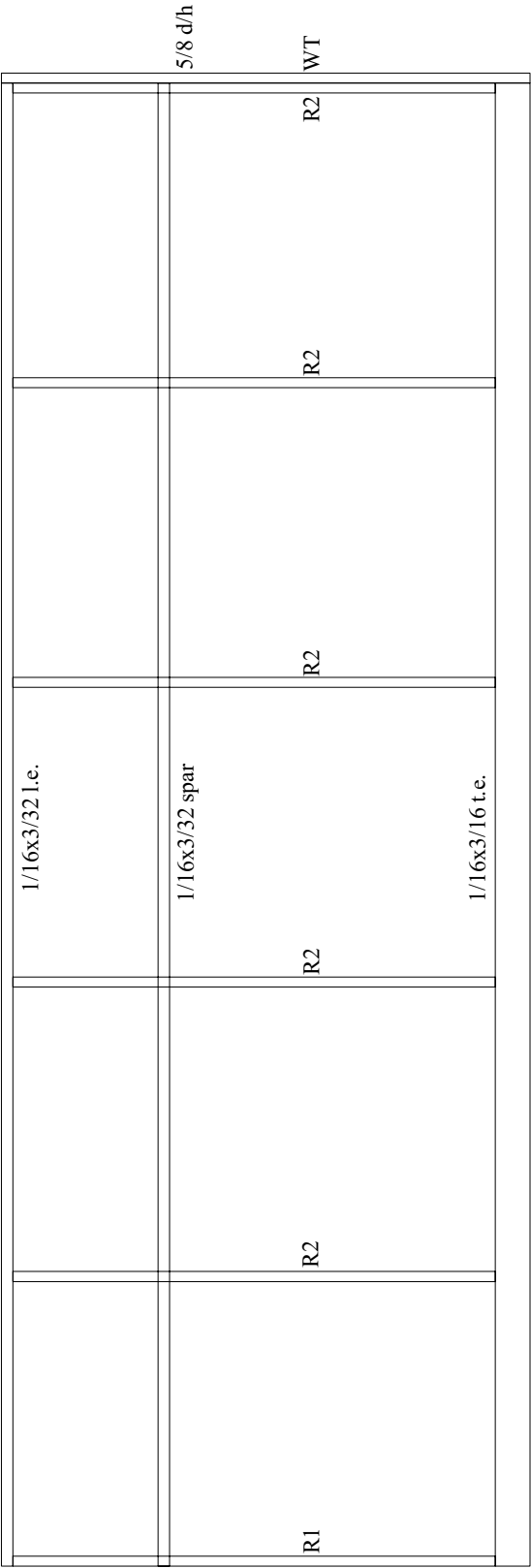

DH 1/64 ply



R1 1/20 balsa